

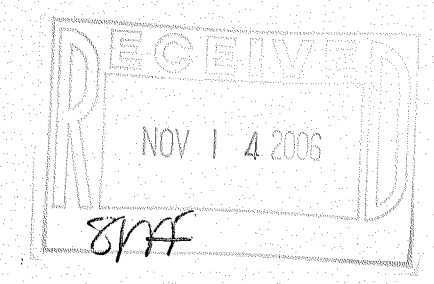

PLAT OF SURVEY  
LOTS 7 & 18, ADDITION NO. 1  
COUNTRY CLUB ESTATES  
VILLAGE OF FONTANA-ON-GENEVA LAKE  
WALWORTH COUNTY, WI.



NOTE: COPIES OF THIS MAP TO WHICH THE FOLLOWING CERTIFICATE WILL APPLY SHOW THE SURVEYOR'S ORIGINAL SEAL AND SIGNATURE IN RED INK. COPIES BY ANY OTHER MEANS MAY HAVE ALTERATIONS WHICH DO NOT REPRESENT THE SURVEYOR'S WORK PRODUCT.

I HEREBY CERTIFY THAT THE ABOVE DESCRIBED PROPERTY HAS BEEN SURVEYED UNDER MY DIRECTION AND THAT THE ABOVE MAP IS A TRUE REPRESENTATION THEREOF AND SHOWS THE SIZE AND LOCATION OF THE PROPERTY AND ITS EXTERIOR BOUNDARIES. THIS SURVEY IS MADE FOR THE USE OF THE PRESENT OWNERS OF THE PROPERTY, AND ALSO THOSE WHO PURCHASE, MORTGAGE, OR GUARANTEE THE TITLE THERETO WITHIN ONE YEAR FROM THE DATE HEREOF.

DATED: OCTOBER 25, 2006

PETER S. GORDON  
R.L.S. 2101

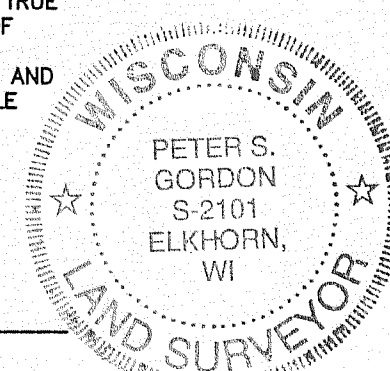

WORK ORDERED BY:  
ERNIE TUCHESCHERER  
PO BOX 259  
FONTANA, WI. 53125

FARRIS, HANSEN & ASSOCIATES, INC.  
ENGINEERING - ARCHITECTURE - SURVEYING  
7 RIDGEWAY COURT P.O. BOX 437  
ELKHORN, WISCONSIN 53121  
OFFICE: (262) 723-2098 FAX: (262) 723-5886

REVISIONS

PROJECT NO.  
7157  
DATE:  
10-20-06  
SHEET NO.  
1 OF 1

10/25/2006 X:\Projects\7157\DCAD\SURVEY

CT -7 SCT-18

005 - 2/24